



Goldendunes Infratech Pvt. Ltd.
Corporate Office: C- 6, Vashishth Marg, Hanuman Nagar Block 'C', Vaishali Nagar, Jaipur, Rajasthan - 302021
T: +91 141-4012 808 | E: contact@purplegroup.org | W: www.purplegroup.org

Goa Office: A- 403, 4th Floor, Saldanha Business Tower, Near Court Circle, Mapusa, Goa
T: +91 832-2256 853, 77220 89148

RERA Registration Number :

RERA Website : rera.goa.gov.in

Disclaimer: The views shown in the picture are as presently available and they may vary over period of time. All intending purchaser/s are bound to inspect all plans and approvals and apprise themselves of all plans and approvals and other relevant information portal like RERA website and nothing in this brochure/advertisement or other documents is intended to substitute to the intending purchaser the actual plans and approvals obtained from time to time. The relationship between the developer and the actual customers will be governed strictly by the agreements to be executed from time to time and not on the terms of this brochure/advertisement or other promotional document.



9314 - 880 - 808

or Log onto: www.purplegroup.org

Concept & Design by: www.nimodesigns.com

PURPLE'S AMOUR

2 & 3 BHK Apartments | Karaswada, Mapusa, Goa





love where you live

Life is a sum total of moments that you live and love. Living life to the fullest is a series of experiences that live with you throughout your life. These are the moments where you explore life and make a true sense of your being. The real joy of life lies in the fact that your world is full of bliss and you love to live every aspect of it.

Go, make your life a story of beautiful memories and call it a fable of love.

am

because
when the world becomes
a distant sound

music of life plays



Have you ever imagined a life where time is not the yardstick and you have your life the way you like it. The world becomes a distant existence and you indulge in the melody of life. It's when life illustrates a delightful picture of moments and you reflect the joy of living carefree. Obviously you deserve all this without any conditions and making any effort. Make space for yourself and get ready to dance to the tune of happiness without thinking about the world.





Artistic impression



PURPLE'S AMOUR

2 & 3 BHK Apartments | Karaswada, Mapusa, Goa

Purple Amour is a world full of wonderful things. The project pampers you with its immaculate design and scientific planning. Amour offers space for every need and desire and celebrates life in full glory. Amenities in Amour create a bouquet of experiences and turn your life into a never-ending celebration. More than just a residence, Amour is a sweet expression of life that sets you free to live and be the way you love it. Come, start an affair with life and open up to a world of sweet surprises.

project highlights

- CCTV Camera on Main Entrance
- Gated Complex with 24 Hrs High-tech Security
- Electric Video Door Phone
- Multi Purpose Courtyard
- Walking Track with Aroma Garden
- Children's Play Area
- Amphitheatre
- Landscaped Garden
- Gazebo
- Clubhouse
- Indoor Games Area
- Swimming/Rain Pool
- Waiting Area with Reception
- Society Office
- Gymnasium
- Party Hall with Kitchen



because
when mundane existence
takes a pause

rhythm of life begins



Living in Goa is an out-of-the world idea and living in Amour is simply paradise. Life at Amour gives you a break from the typical routined life. Be it inside your home or strolling outside, life here is an extended vacation that treats you with all flavours in its own unique way. Live in a stress-free world and make the most of every moment. Amour is your passport to experience a world that compliments your existence in a big way. Come, belong to a place that has no parallels and that is yours in every sense.



the location

Purple Amour is a new landmark of Goa that connects you to everything important and beautiful. Once you are at Amour, nothing is far from you. Whatever you need or wish for is conveniently connected. Live the joy of having everything and living everything without going far from your beautiful abode. Amour is essentially connected to you and it connects you to things and places of your choice. Live in the surroundings where you have many invitations to explore a lifestyle you belong to.

the social infrastructure

 Adjoined to NH-66	 1 Min Drive from Fuel Filling Station	 1 Min Drive from the Nearest Church/Temple
 2 Min Drive from North Goa Govt. Hospital	 2 Min Drive from All Leading Banks	 2-3 Min Drive from Duler Stadium
 3 Min Drive from Sports Complex Peddem	 3-5 Min Drive from World-class Schools & Colleges	 5 Min Drive from District Court
 6 Min Drive from Mapusa Market	 6 Min Drive from Mapusa Industrial Area	 6 Min Drive from District Office/Municipal Office
 6 Min Drive from Mapusa Bus Stand	 10 Min Drive from the Nearest Beach	 30 Min Drive from Mopa Upcoming International Airport





Artistic impression



Artistic impression

Amour's architecture reflects hues of aesthetics in a very elegant way. Each fine detail presents lifestyle in a very unique and defining way. Purple Amour creates a perfect balance between science of living and the art of lifestyle. There are things that make Amour a masterpiece of aspirations. You can touch and feel the difference and live it with all heart. Own a living that draws new patterns of beauty and sophistication.



because
when smile becomes
the graph of life

melody begins to flow



amphitheatre



kids play area



Artistic impression

because
when deep desires
take a stroll

sound of life becomes poetic



Life at Amour is all about living openness and giving wings to imagination. Courtyard at the project is designed to welcome residents to an open and beautiful world. There are spaces specially designed to treat you with relaxed moments and make life enjoyable. Amour boasts big size balconies that are perfect to sip a morning cup of steamy tea or just have a chit chat during that monsoon shower. Open up to a feeling of absolute pleasure.



Artistic impression

landscape courtyard



living area

Artistic impression



kitchen

Artistic impression

A good interior talks a lot about its dweller and Amour presents an inspiring layout of a well-placed life. Each corner of the home is perfectly designed to ensure proper air and light flow. On the aesthetic front, Amour spaces create a positive aura and make a progressive canvas for life. For every member of the family, the project offers clearly defined spaces equipped with positive energy and amenities. In short, it's an internal world with a perfect outward perspective.



master bedroom



other bedroom

Artistic impression

Artistic impression



club
**SEVEN
SEAS**

Indulge in the lap of luxury

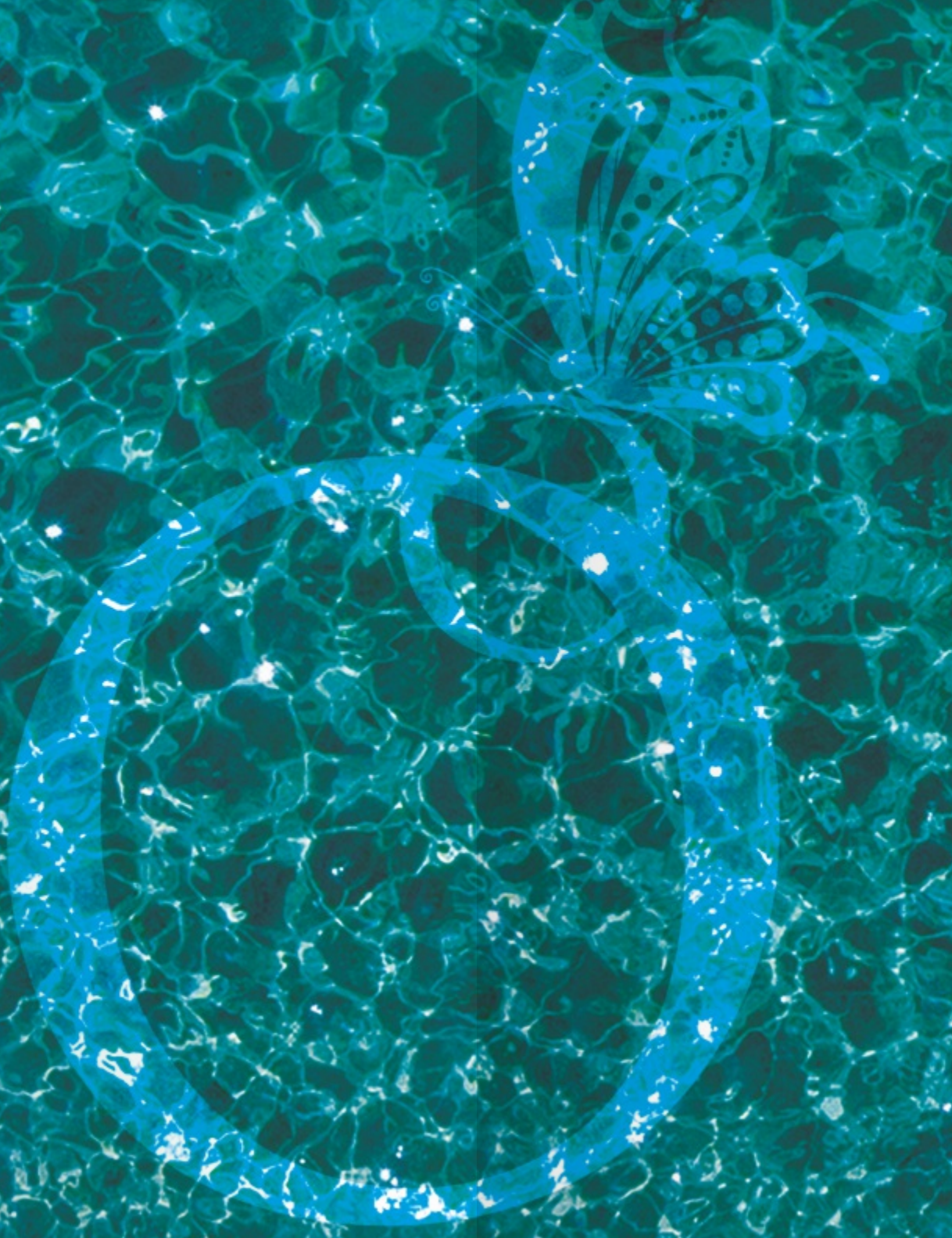



Artistic impression

because
when social life becomes
a celebration



every moment turns into a memory

Social life is an inviting story at Amour. The clubhouse here is a place to be and enjoy. Here, you can find an array of amenities to live a social life that has many shades of joy and celebration. So, if you are someone who loves to socialize in style then Amour is your address. Adults, kids and senior citizens have their own share in the scheme of things here. It's about socializing, making an impact and living everything larger-than-life.



Artistic impression

swimming pool



waiting lounge



gymnasium



indoor games room

Artistic impression



multipurpose hall

Artistic impression



library

Artistic impression



society office

Artistic impression



PURPLE'S AMOUR

2 & 3 BHK Apartments | Karaswada, Mapusa, Goa

Amour is a comfortably placed world where life blossoms in the colours of sheer bliss. The project houses a less dense population and provides a significant share of facilities and features to all individuals. Project's grand entry welcomes you with all style and glory. There are open spaces to help people extend their world beyond the periphery of defined parameters. Give life a chance to celebrate the beauty of moments everyday with a smile on your face.





LANDSCAPED *master plan*

legends

- 1. Security Cabin
- 2. Entrance Gate
- 3. Palm Trees
- 4. Creepers
- 5. Water Feature
- 6. Grass Jointed Paving
- 7. Entrance Plaza
- 8. Water Fountain
- 9. Tree Pit with Seating Around
- 10. Swimming Pool
- 11. Indoor Play Area
- 12. Gymnasium
- 13. Reading Area
- 14. Activity Area
- 15. Society Office
- 16. Party Hall
- 17. Peripheral Walk Way
- 18. Lawn
- 19. Amphitheatre Seating
- 20. Stage
- 21. EPDM Kids Play Area
- 22. Grass Jointed Paving
- 23. Multipurpose Courtyard





BLOCK A & B
lower ground floor plan





BLOCK A & B (Upper Ground, 2nd, 4th & 6th)

typical floor plan

area table

Flat No.	TYPE	SBUA (In Sq. Mtrs.)
A001	3BHK	147.44
A002	2BHK	104.29
A003	2BHK	104.86
A004	2BHK	103.08
A005	2BHK	102.46
A006	3BHK	147.44
B001	2BHK	108.32
B002	2BHK	114.86
B003	2BHK	109.86
B004	2BHK	103.32



Disclaimer: The project is having total 7 floors (still, upper ground, 1st, 2nd, 3rd & 4th floor) in "Phase-I" and it is approved by the authorities. "Phase-II" is the future extension planned over 4th, 5th & 6th floor (approvals are under process with the authorities)



BLOCK A & B (1st, 3rd & 5th)
typical floor plan

area table

Flat No.	TYPE	SBUA (In Sq. Mtrs.)
A101	3BHK	145.12
A102	2BHK	102.06
A103	2BHK	102.63
A104	2BHK	100.85
A105	2BHK	100.23
A106	3BHK	145.12
B101	2BHK	106.09
B102	2BHK	112.63
B103	2BHK	107.62
B104	2BHK	101.09



Disclaimer: The project is having total 7 floors (stilt, upper ground, 1st, 2nd, 3rd & 4th floor) in 'Phase-I' and it is approved by the authorities. 'Phase-II' is the future extension planned over 4th, 5th & 6th floor (approvals are under process with the authorities)



BLOCK C & D (Upper Ground, 2nd, 4th & 6th)

typical floor plan

area table

Flat No.	TYPE	SBUA (In Sq. Mtrs.)
D001	2BHK	114.86
D002	2BHK	108.31
D003	2BHK	103.33
D004	2BHK	109.89
C001	2BHK	106.38
C002	2BHK	104.13
C003	2BHK	104.86
C004	2BHK	103.05
C005	2BHK	102.31
C006	2BHK	106.38



Disclaimer: The project is having total 7 floors (still, upper ground, 1st, 2nd, 3rd & 4th floor) in "Phase-I" and it is approved by the authorities. "Phase-II" is the future extension planned over 4th, 5th & 6th floor (approvals are under process with the authorities)



BLOCK C & D (1st, 3rd & 5th)
typical floor plan

area table

Flat No.	TYPE	SBUA (In Sq. Mtrs.)
D101	2BHK	112.63
D102	2BHK	106.08
D103	2BHK	101.10
D104	2BHK	107.66
C101	2BHK	104.15
C102	2BHK	101.90
C103	2BHK	105.68
C104	2BHK	103.87
C105	2BHK	100.08
C106	2BHK	104.15



Disclaimer: The project is having total 7 floors (still, upper ground, 1st, 2nd, 3rd & 4th floor) in "Phase-I" and it is approved by the authorities. "Phase-II" is the future extension planned over 4th, 5th & 6th floor (approvals are under process with the authorities)



BLOCK A & B
4th floor plan



Disclaimer: The project is having total 7 floors (stilt, upper ground, 1st, 2nd, 3rd & 4th floor) in 'Phase-I' and it is approved by the authorities. 'Phase-II' is the future extension planned over 4th, 5th & 6th floor (approvals are under process with the authorities)



BLOCK C & D
4th floor plan



Disclaimer: The project is having total 7 floors (still, upper ground, 1st, 2nd, 3rd & 4th floor) in "Phase-I" and it is approved by the authorities. "Phase-II" is the future extension planned over 4th, 5th & 6th floor (approvals are under process with the authorities)

 unit plan

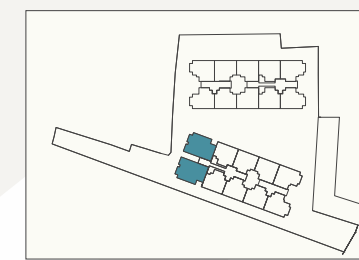

KEY PLAN



3 BHK CARPET AREA: 87.45 Sq. Mtr. | BUA: 126.08 Sq. Mtr. | SBUA: 147.44 Sq. Mtr.

Flat No: A-001 & A-006

 unit plan

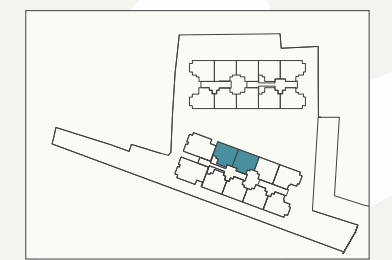

KEY PLAN



2 BHK CARPET AREA: 64.52 Sq. Mtr. | BUA: 89.17 Sq. Mtr. | SBUA: 104.86 Sq. Mtr.

Flat No: A-002 & A-003

 unit plan

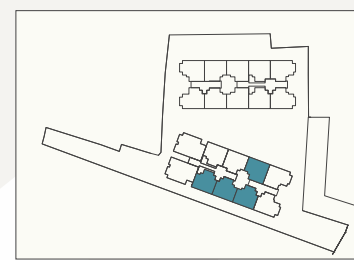

KEY PLAN



2 BHK CARPET AREA: 67.66 Sq. Mtr. | BUA: 92.12 Sq. Mtr. | SBUA: 108.32 Sq. Mtr.

Flat No: A-005, A-004, B-004 & B-001

 unit plan

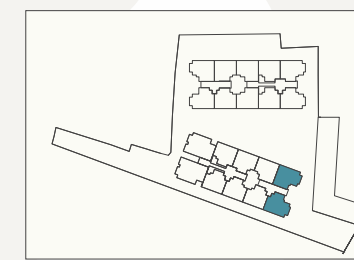

KEY PLAN



2 BHK CARPET AREA: 67.66 Sq. Mtr. | BUA: 97.86 Sq. Mtr. | SBUA: 114.86 Sq. Mtr.

Flat No: B-002 & B-003

 unit plan



2 BHK CARPET AREA: 67.64 Sq. Mtr. | BUA: 92.17 Sq. Mtr. | SBUA: 108.31 Sq. Mtr.

Flat No: D-002, D-003, C-001 & C-006

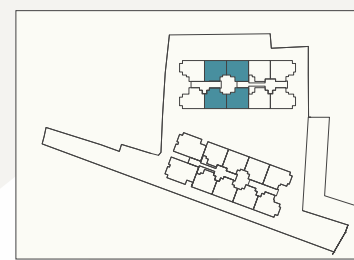

KEY PLAN



 unit plan



2 BHK CARPET AREA: 64.50 Sq. Mtr. | BUA: 89.19 Sq. Mtr. | SBUA: 104.86 Sq. Mtr.

Flat No: C-003 & C-004

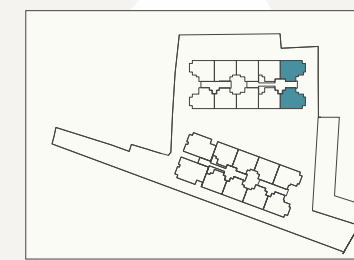

KEY PLAN



 unit plan

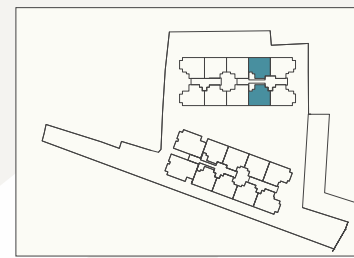

KEY PLAN



2 BHK CARPET AREA: 64.50 Sq. Mtr. | BUA: 88.53 Sq. Mtr. | SBUA: 104.13 Sq. Mtr.

Flat No: C-002 & C-005

 unit plan

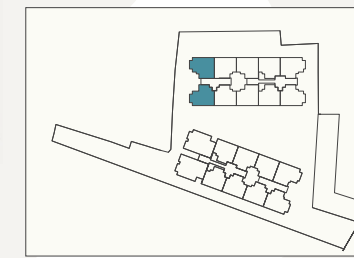

KEY PLAN



2 BHK CARPET AREA: 67.64 Sq. Mtr. | BUA: 97.86 Sq. Mtr. | SBUA: 114.86 Sq. Mtr.

Flat No: D-001 & D-004



general specifications

 Housekeeping Services (Optional)	 Kitchen /Cafeteria	 Clubhouse	 Swimming Pool
 Fully-equipped Gymnasium	 Party Hall with Kitchen	 Landscape Garden	 Security
 24x7 CCTV in Common Areas	 10 Passenger Lifts	 Basement Parking	 Solid Waste Management
 Earthquake Resistant Structure	 Fire Fighting System	 Solar Power in Common Areas	 Back-up Generators in Common Areas

and many more...



standard specifications

Structure : RCC framed structure

Walls : 23cms and 10cms ACC blocks (Light weight blocks)

Plaster : 1:4 Cement mortar 12mm thick internal plaster finished with putty & 1:3 cement mortar external plaster (sand faced)

Flooring : Wooden tiles in master bedroom
24 x24 Vitrified tiles in all rooms, anti-skid ceramic tiles for toilet floor & concept tiles for dado
Sand stone/Granite/Kota stone for staircase

Semi Modular Kitchen : Granite kitchen platform with stainless steel sink with drain board (Jindal or equivalent) 2' dado with concept ceramic tiles

Toilet : Counter basin in master bedroom toilet

Windows : Powder coated Aluminium/UPVC windows

Doors : French doors in balcony powder coated Aluminium/UPVC and glass

Internal Doors : Treated wood frame & flush door

Main Door : 1st class marandi wooden frame & flush doors shutter

Internal Paint : Acrylic emulsion

External Paint : Weather proof paint

Railing : Balcony - MS Railing/Baluster railing or as per elevation (SS)

Staircase : MS railing /SS railing

Plumbing : Piping - CPVC/UPVC

Fixtures : Chrome plated (Jaquar/Grohe) or equivalent

Sanitaryware : CERA, Johnson, Jaquar (white) or equivalent

Electrical : Wires - Finolex/Anchor or equivalent

Switches : Modular switches (Anchor/SSK/Legrand) or equivalent



the makers



Purple Group started its remarkable journey in 2009 with an ambitious vision of reshaping the real estate spectrum by developing high-end living and commercial spaces. A commercial mall & residential apartments in Barmer, an important town situated in the western part of Rajasthan, were the flagship landmarks of the group. The projects garnered overwhelming response from the people of Barmer and poised Purple Group as the fastest growing real estate name in its area of operations.

The next milestone in the journey was a multistorey residential hub in the city of Alwar followed by a commercial-cum-residential project in India's academic hub, Kota. Since then the group has grown by leaps and bounds and established itself as a trusted real estate name with significant leadership qualities. Purple Group's signature projects are considered to be the epitome of lifestyle grandeur and unmatched comfort. Today, the group is poised to mark its presence on the larger spectrum of Rajasthan's real estate by expanding its footprints across the length and the breadth of the state while realising its larger well-defined vision.

some of our other projects



SYMPHONIA
Main Vaishali Nagar, Jaipur



MELODIA
Main Vaishali Nagar, Jaipur



PANACHE
Gandhi Nagar, Alwar

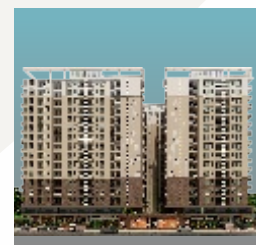

VIVANTA
Shrinathpuram, Kota



CITY CENTRE
C-1, Mahaveer Nagar, Barmer

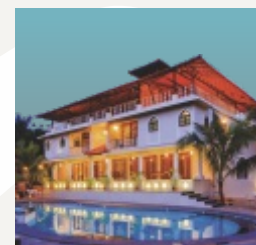

AURA (RESORT)
Mandrem, North Goa



the team of experts



STUDIO ARCHETYPE

Project Architects

Studio Archetype is a multi disciplinary architectural, interior design and urban planning firm based in Goa, India since 1999. Studio Archetype offices in Panaji and Mapusa and have designed numerous projects including individual villas, residential complexes, commercial buildings, hotels, resorts and urban design projects of various scales in Goa. Studio Archetype is empanelled as consultants with the Goa State Urban Development Agency (GSUDA) and are consultants for various development projects for Mapusa Municipal Council.



ELEMENTS DESIGN STUDIO

Project Landscaping Architect

Elements Design Studio is a nature inspired firm with modern design values and a grounded approach to landscape architecture. The firm takes a holistic approach to design, being sensitive to the flora and fauna which is aboriginal to the state and its climatic conditions.

RAJESH MAHAMBREY & ASSOCIATES

Project Structural Engineer

Rajesh Mahambrey & Associates is structural consultancy firm based at Mapusa – Goa since 1997. The firm has designed various types of projects which includes industries, commercial complexes, residential towers, hotels and resorts in Goa as well as in Mumbai.

Luxury Redefined



AMRITARA HOTELS & RESORTS PVT. LTD.

